

Materiale: GG 20-25
Rundløbskast: DIN 7867
Planløbskast: DIN 7867
Overfladeruhed: ISO 254
Afbalancering: ISO 1940 -VDI 2060

Skiver med dm (middel diam.) >125 mm afbalanceres statisk G 6,3.
 Dog accepteres en restubalance på 2 g på skivens dm (middel diam.).
 Restubalancen er ≤100 g mm/kg ved 600 o./min. og 20 g mm/kg ved 3000 o./min.
 Efter ordre leveres også dynamisk G 6,3-G 2,5.

Material: Fine grain cast-iron grade 220-260
Eccentricity of O/D to bore: DIN 7867
Groove side wobble tolerance: DIN 7867
Surface roughness: ISO 254
Balance quality grade: ISO 1940 -VDI 2060

Pulleys with dm (pcd) >125 mm are statically balanced to grade G 6,3.
 A residual unbalance of 2 g on the pulley dm (pcd) will be accepted.
 The residual unbalance is ≤100 g mm/kg at 600 rev./min. and 20 g mm/kg at 3000 rev./min.
 Dynamic G 6,3-G 2,5 balancing can be supplied to order.

Material: Hochwertiger Grauguss GG 20 - GG 25
Rundlauf-Genauigkeit: DIN 7867
Planlauf-Genauigkeit: DIN 7867
Oberfläche Rauheit: ISO 254
Auswucht-Gütestufe: ISO 1940 -VDI 2060

Scheiben mit dm (dw) > 125 mm werden statisch ausgewuchtet, Gütestufe G 6,3, jedoch wird eine Restunwucht auf 2 g am Scheiben dm (dw) akzeptiert.
 Die Restunwucht beträgt ≤100 g mm/kg bei 600 u./min. und 20 g mm/kg bei 3000 u./min.
 Nach Vereinbarung in zwei Ebenen, Gütestufe G 6,3-G 2,5.

PROFIL J

Spor / Grooves / Rillen	4	8	12	16	20
B(mm)	13,5	23	32,5	42	52
F(mm)	3,24	3,31	3,38	3,45	3,77

Sporafstand	2,34
C. D. of grooves	
Rillenabstand	

PROFIL L

Spor / Grooves / Rillen	6	8	10	12	16	20
B(mm)	38,5	48	57	67	86	105
F(mm)	7,5	7,55	7,35	7,65	7,75	7,85

Sporafstand	4,70
C. D. of grooves	
Rillenabstand	

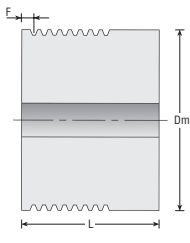

Figur 1

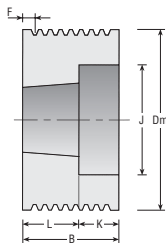

Figur 2

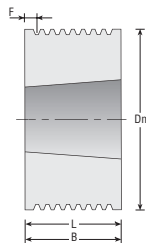

Figur 3

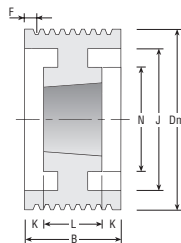

Figur 5

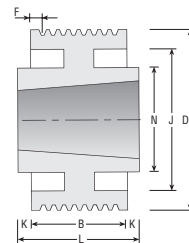

Figur 6

Dm	Spor Grooves		Part Nr.	Taper Bush Type	Fig.	L	K	N	J	d	Dm	Spor Grooves		Part Nr.	Taper Bush Type	Fig.	L	K	N	J	d
	Rillen	Mat.										Rillen	Mat.								
20	4	GG	PJ02004N	-	1	22.5	-	-	-	5	63	4	GG	PJ06304T	1108	7	23	9.5	50	-	-
	8	GG	PJ02008N	-	1	32	-	-	-	5		8	GG	PJ06308T	1108	3	23	-	-	-	-
	12	GG	PJ02012N	-	1	41.5	-	-	-	5		12	GG	PJ06312T	1108	2	23	9.5	-	45	-
	16	GG	PJ02016N	-	1	51	-	-	-	5		16	GG	PJ06316N	-	1	51	-	-	-	12
	20	GG	PJ02020N	-	1	61	-	-	-	5		20	GG	PJ06320N	-	1	61	-	-	-	12
25	4	GG	PJ02504N	-	1	22.5	-	-	-	5	67	4	GG	PJ06704T	1108	7	23	9.5	50	-	-
	8	GG	PJ02508N	-	1	32	-	-	-	5		8	GG	PJ06708T	1108	3	23	-	-	-	-
	12	GG	PJ02512N	-	1	41.5	-	-	-	5		12	GG	PJ06712T	1108	2	23	9.5	-	51	-
	16	GG	PJ02516N	-	1	51	-	-	-	5		16	GG	PJ06716N	-	1	51	-	-	-	12
	20	GG	PJ02520N	-	1	61	-	-	-	5		20	GG	PJ06720N	-	1	61	-	-	-	12
30	4	GG	PJ03004N	-	1	22.5	-	-	-	9.5	71	4	GG	PJ07104T	1108	7	23	9.5	60	-	-
	8	GG	PJ03008N	-	1	32	-	-	-	9.5		8	GG	PJ07108T	1108	3	23	-	-	-	-
	12	GG	PJ03012N	-	1	41.5	-	-	-	9.5		12	GG	PJ07112T	1108	2	23	9.5	-	55	-
	16	GG	PJ03016N	-	1	51	-	-	-	9.5		16	GG	PJ07116T	1215	3	42	-	-	55	-
	20	GG	PJ03020N	-	1	61	-	-	-	9.5		20	GG	PJ07120T	1215	2	42	10	-	55	-
35	4	GG	PJ03504N	-	1	22.5	-	-	-	9.5	75	4	GG	PJ07504T	1108	7	23	9.5	60	-	-
	8	GG	PJ03508N	-	1	32	-	-	-	9.5		8	GG	PJ07508T	1108	3	23	-	-	-	-
	12	GG	PJ03512N	-	1	41.5	-	-	-	9.5		12	GG	PJ07512T	1210	2	26	6.5	-	59	-
	16	GG	PJ03516N	-	1	51	-	-	-	9.5		16	GG	PJ07516T	1610	2	26	16	-	59	-
	20	GG	PJ03520N	-	1	61	-	-	-	9.5		20	GG	PJ07520T	1615	2	42	10	-	59	-
40	4	GG	PJ04004N	-	1	22.5	-	-	-	12	80	4	GG	PJ08004T	1310	7	26	12.5	70	-	-
	8	GG	PJ04008N	-	1	32	-	-	-	12		8	GG	PJ08008T	1310	7	26	3	70	-	-
	12	GG	PJ04012N	-	1	41.5	-	-	-	12		12	GG	PJ08012T	1610	2	26	6.5	-	64	-
	16	GG	PJ04016N	-	1	51	-	-	-	12		16	GG	PJ08016T	1610	2	26	16	-	64	-
	20	GG	PJ04020N	-	1	61	-	-	-	12		20	GG	PJ08020T	1615	2	42	10	-	64	-
45	4	GG	PJ04504N	-	1	22.5	-	-	-	12	85	4	GG	PJ08504T	1310	7	26	12.5	70	-	-
	8	GG	PJ04508N	-	1	32	-	-	-	12		8	GG	PJ08508T	1310	7	26	3	70	-	-
	12	GG	PJ04512N	-	1	41.5	-	-	-	12		12	GG	PJ08512T	1610	2	26	6.5	-	69	-
	16	GG	PJ04516N	-	1	51	-	-	-	12		16	GG	PJ08516T	1610	2	26	16	-	69	-
	20	GG	PJ04520N	-	1	61	-	-	-	12		20	GG	PJ08520T	1615	2	42	10	-	69	-
50	4	GG	PJ05004N	-	1	22.5	-	-	-	12	90	4	GG	PJ09004T	1610	7	26	12.5	82	-	-
	8	GG	PJ05008N	-	1	32	-	-	-	12		8	GG	PJ09008T	1610	7	26	3	82	-	-
	12	GG	PJ05012N	-	1	41.5	-	-	-	12		12	GG	PJ09012T	1610	2	26	6.5	-	74	-
	16	GG	PJ05016N	-	1	51	-	-	-	12		16	GG	PJ09016T	1610	2	26	16	-	74	-
	20	GG	PJ05020N	-	1	61	-	-	-	12		20	GG	PJ09020T	1615	2	42	10	-	74	-
56	4	GG	PJ05604T	1108	7	23	9.5	50	-	-	95	4	GG	PJ09504T	1610	7	26	12.5	82	-	-
	8	GG	PJ05608T	1108	3	23	-	-	-	-		8	GG	PJ09508T	1610	7	26	3	82	-	-
	12	GG	PJ05612N	-	1	41.5	-	-	-	12		12	GG	PJ09512T	1610	2	26	6.5	-	79	-
	16	GG	PJ05616N	-	1	51	-	-	-	12		16	GG	PJ09516T	1610	2	26	16	-	79	-
	20	GG	PJ05620N	-	1	61	-	-	-	12		20	GG	PJ09520T	1615	2	42	10	-	79	-
60	4	GG	PJ06004T	1108	7	23	9.5	50	-	-	100	4	GG	PJ10004T	1610	7	26	12.5	82	-	-
	8	GG	PJ06008T	1108	3	23	-	-	-	-		8	GG	PJ10008T	1610	7	26	3	82	-	-
	12	GG	PJ06012T	1108	2	23	9.5	-	45	-		12	GG	PJ10012T	1610	2	26	6.5	-	82	-
	16	GG	PJ06016N	-	1	51	-	-	-	12		16	GG	PJ10016T	1610	2	26	16	-	82	-
	20	GG	PJ06020N	-	1	61	-	-	-	12		20	GG	PJ10020T	1615	2	42	10	-	82	-

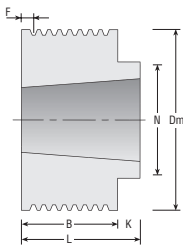

Figur 7

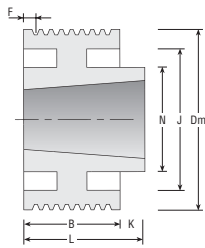

Figur 8

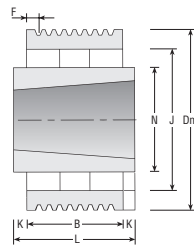

Figur 9

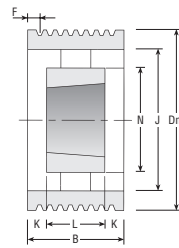

Figur 10

Dm	Spor Grooves		Part Nr.	Taper Bush Type	Fig.	L	K	N	J	d
	Rillen	Mat.								
106	4	GG	PJ10604T	1610	7	26	12.5	88	-	-
	8	GG	PJ10608T	1610	7	26	3	88	-	-
	12	GG	PJ10612T	1610	2	26	6.5	-	88	-
	16	GG	PJ10616T	1610	2	26	16	-	88	-
	20	GG	PJ10620T	1615	2	42	10	-	88	-
112	4	GG	PJ11204T	1610	7	26	12.5	90	-	-
	8	GG	PJ11208T	1610	7	26	3	90	-	-
	12	GG	PJ11212T	1610	2	26	6.5	-	94	-
	16	GG	PJ11216T	1610	2	26	16	-	94	-
	20	GG	PJ11220T	1615	2	42	10	-	94	-
118	4	GG	PJ11804T	1610	7	26	12.5	90	-	-
	8	GG	PJ11808T	1610	7	26	3	90	-	-
	12	GG	PJ11812T	2012	2	32	0.5	-	98	-
	16	GG	PJ11816T	2012	2	32	10	-	98	-
	20	GG	PJ11820T	2012	2	32	20	-	98	-
125	4	GG	PJ12504T	1610	8	26	12.5	90	109	-
	8	GG	PJ12508T	1610	8	26	3	90	109	-
	12	GG	PJ12512T	2012	2	32	0.5	-	105	-
	16	GG	PJ12516T	2012	2	32	10	-	105	-
	20	GG	PJ12520T	2517	2	45	7	-	105	-
132	4	GG	PJ13204T	1610	8	26	12.5	90	116	-
	8	GG	PJ13208T	1610	8	26	3	90	116	-
	12	GG	PJ13212T	2012	2	32	0.5	-	112	-
	16	GG	PJ13216T	2012	2	32	10	-	112	-
	20	GG	PJ13220T	2517	2	45	7	-	112	-
140	4	GG	PJ14004T	1610	8	26	12.5	90	124	-
	8	GG	PJ14008T	1610	8	26	3	90	124	-
	12	GG	PJ14012T	2517	7	45	12.5	120	-	-
	16	GG	PJ14016T	2517	7	45	3	120	-	-
	20	GG	PJ14020T	2517	2	45	7	-	124	-
160	4	GG	PJ16004T	2012	8	32	18.5	110	144	-
	8	GG	PJ16008T	2012	8	32	9	110	144	-
	12	GG	PJ16012T	2517	8	45	12.5	120	140	-
	16	GG	PJ16016T	2517	8	45	3	120	140	-
	20	GG	PJ16020T	2517	2	45	7	-	140	-
180	4	GG	PJ18004T	2012	6	32	9.25	110	164	-
	8	GG	PJ18008T	2012	6	32	4.5	110	164	-
	12	GG	PJ18012T	2517	6	45	6.25	120	160	-
	16	GG	PJ18016T	2517	6	45	1.5	120	160	-
	20	GG	PJ18020T	2517	5	45	3.5	120	160	-
200	4	GG	PJ20004T	2012	6	32	9.25	110	185	-
	8	GG	PJ20008T	2012	6	32	4.5	110	185	-
	12	GG	PJ20012T	2517	6	45	6.25	120	180	-
	16	GG	PJ20016T	2517	6	45	1.5	120	180	-
	20	GG	PJ20020T	2517	5	45	3.5	120	180	-

Dm	Spor Grooves		Part Nr.	Taper Bush Type	Fig.	L	K	N	J	d
	Rillen	Mat.								
224	4	GG	PJ22404T	2012	6	32	9.25	110	208	-
	8	GG	PJ22408T	2012	6	32	4.5	110	208	-
	12	GG	PJ22412T	2517	6	45	6.25	120	204	-
	16	GG	PJ22416T	2517	6	45	1.5	120	204	-
	20	GG	PJ22420T	2517	5	45	3.5	120	204	-
250	4	GG	PJ25004T	2012	9	32	9.25	110	234	-
	8	GG	PJ25008T	2012	9	32	4.5	110	234	-
	12	GG	PJ25012T	2517	6	45	6.25	120	230	-
	16	GG	PJ25016T	2517	6	45	1.5	120	230	-
	20	GG	PJ25020T	2517	5	45	3.5	120	230	-
280	4	GG	PJ28004T	2012	9	32	9.25	110	264	-
	8	GG	PJ28008T	2012	9	32	4.5	110	264	-
	12	GG	PJ28012T	2517	9	45	6.25	120	260	-
	16	GG	PJ28016T	2517	9	45	1.5	120	260	-
	20	GG	PJ28020T	2517	10	45	3.5	120	260	-
315	4	GG	PJ31504T	2012	9	32	9.25	110	299	-
	8	GG	PJ31508T	2012	9	32	4.5	110	299	-
	12	GG	PJ31512T	2517	9	45	6.25	120	295	-
	16	GG	PJ31516T	2517	9	45	1.5	120	295	-
	20	GG	PJ31520T	2517	10	45	3.5	120	295	-
355	4	GG	PJ35504T	2517	9	45	15.7	120	339	-
	8	GG	PJ35508T	2517	9	45	11	120	339	-
	12	GG	PJ35512T	2517	9	45	6.25	120	335	-
	16	GG	PJ35516T	3020	9	52	5	146	335	-
	20	GG	PJ35520T	3020	10	52	-	146	335	-
400	4	GG	PJ40004T	2517	9	45	15.75	120	380	-
	8	GG	PJ40008T	2517	9	45	11	120	380	-
	12	GG	PJ40012T	2517	9	45	6.25	120	380	-
	16	GG	PJ40016T	3020	9	52	5	146	380	-
	20	GG	PJ40020T	3020	10	52	-	146	380	-

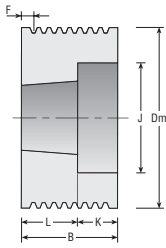

Figur 2

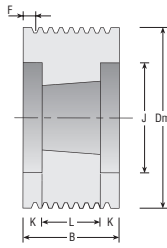

Figur 4

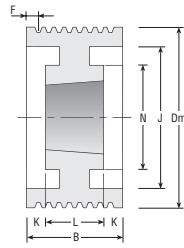

Figur 5

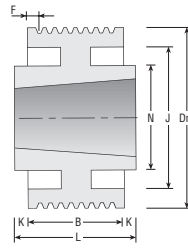

Figur 6

Dm	Spor Grooves		Part Nr.	Taper Bush Type	Fig.	L	K	N	J	Dm	Spor Grooves		Part Nr.	Taper Bush Type	Fig.	L	K	N	J	
	Rillen	Mat.									Rillen	Mat.								
75	6	GG	PL07506T	1210	2	26	12.5	-	56	125	6	GG	PL12506T	2012	2	32	6.5	-	101	
	8	GG	PL07508T	1210	2	26	22	-	56		8	GG	PL12508T	2012	2	32	16	-	101	
	10	GG	PL07510T	1215	2	42	15	-	56		10	GG	PL12510T	2517	4	45	6	-	101	
	12	GG	PL07512T	1215	2	42	25	-	56		12	GG	PL12512T	2517	4	45	11	-	101	
80	6	GG	PL08006T	1210	2	26	12.5	-	56	16	16	GG	PL12516T	2517	4	45	20.5	-	101	
	8	GG	PL08008T	1210	2	26	22	-	56		20	GG	PL12520T	2517	4	45	30	-	101	
	10	GG	PL08010T	1215	2	42	15	-	56		132	6	GG	PL13206T	2012	2	32	6.5	-	108
	12	GG	PL08012T	1215	2	42	25	-	56			8	GG	PL13208T	2012	2	32	16	-	108
10	GG	PL08506T	1210	2	26	12.5	-	61	10	GG		PL13210T	2517	4	45	6	-	108		
12	GG	PL08508T	1210	2	26	22	-	61	12	GG		PL13212T	2517	4	45	11	-	108		
85	10	GG	PL08510T	1215	2	42	15	-	61	16	16	GG	PL13216T	2517	4	45	20.5	-	108	
	12	GG	PL08512T	1215	2	42	25	-	61		20	GG	PL13220T	2517	4	45	30	-	108	
	12	GG	PL09006T	1610	2	26	12.5	-	66		140	6	GG	PL14006T	2517	7	45	6.5	120	-
	8	GG	PL09008T	1610	2	26	22	-	66			8	GG	PL14008T	2517	2	45	3	-	116
10	GG	PL09010T	1615	2	42	15	-	66	10	GG		PL14010T	2517	4	45	6	-	116		
12	GG	PL09012T	1615	2	42	25	-	66	12	GG		PL14012T	2517	4	45	11	-	116		
90	16	GG	PL09016T	1615	4	42	22	-	66	150	16	GG	PL14016T	2517	4	45	20.5	-	116	
	6	GG	PL09506T	1610	2	26	12.5	-	71		6	GG	PL15006T	2517	7	45	6.5	120	-	
	8	GG	PL09508T	1610	2	26	22	-	71		8	GG	PL15008T	2517	2	45	3	-	126	
	10	GG	PL09510T	1615	2	42	15	-	71		10	GG	PL15010T	2517	4	45	6	-	126	
95	12	GG	PL09512T	1615	2	42	25	-	71	160	12	GG	PL15012T	2517	4	45	11	-	126	
	16	GG	PL09516T	1615	4	42	22	-	71		16	GG	PL15016T	2517	4	45	20.5	-	126	
	6	GG	PL10006T	1610	2	26	12.5	-	76		20	GG	PL15020T	3020	4	52	26.5	-	126	
	8	GG	PL10008T	1610	2	26	22	-	76		170	6	GG	PL16006T	2517	7	45	6.5	120	-
10	GG	PL10010T	2012	2	32	25	-	79	8	GG		PL16008T	2517	2	45	3	-	136		
12	GG	PL10012T	2012	2	32	35	-	79	10	GG		PL16010T	2517	4	45	6	-	136		
16	GG	PL10016T	2012	4	32	27	-	79	12	GG		PL16012T	2517	4	45	11	-	136		
100	16	GG	PL10606T	1610	2	26	12.5	-	82	180	16	GG	PL16016T	3020	4	52	17	-	136	
	8	GG	PL10608T	1610	2	26	22	-	82		20	GG	PL16020T	3020	4	52	26.5	-	136	
	10	GG	PL10610T	2012	2	32	25	-	82		190	6	GG	PL17006T	2517	8	45	6.5	120	146
	12	GG	PL10612T	2012	2	32	35	-	82			8	GG	PL17008T	2517	2	45	3	-	146
16	GG	PL10616T	2012	4	32	27	-	82	10	GG		PL17010T	2517	4	45	6	-	146		
6	GG	PL11206T	1610	2	26	12.5	-	88	12	GG		PL17012T	2517	4	45	11	-	146		
106	8	GG	PL11208T	1610	2	26	22	-	88	20	16	GG	PL17016T	3020	4	52	17	-	146	
	10	GG	PL11210T	2012	2	32	25	-	88		20	GG	PL17020T	3020	4	52	26.5	-	146	
	12	GG	PL11212T	2012	2	32	35	-	88		180	6	GG	PL18006T	2517	6	45	3.25	120	156
	16	GG	PL11216T	2012	4	32	27	-	88			8	GG	PL18008T	2517	5	45	1.5	120	156
6	GG	PL11806T	2012	2	32	6.5	-	94	10	GG		PL18010T	2517	5	45	6	120	156		
8	GG	PL11808T	2012	2	32	16	-	94	12	GG		PL18012T	2517	5	45	11	120	156		
112	10	GG	PL11810T	2517	4	45	6	-	97	190	16	GG	PL18016T	3020	4	52	17	-	156	
	12	GG	PL11812T	2517	4	45	11	-	97		20	GG	PL18020T	3020	4	52	26.5	-	156	
	16	GG	PL11816T	2517	4	45	20.5	-	97		6	6	GG	PL19006T	2517	6	45	3.25	120	166
	20	GG	PL11820T	2517	4	45	30	-	97			8	GG	PL19008T	2517	5	45	1.5	120	166
6	GG	PL19006T	2517	6	45	3.25	120	166	10	GG		PL19010T	2517	5	45	6	120	166		
8	GG	PL19008T	2517	5	45	1.5	120	166	12	GG		PL19012T	2517	5	45	11	120	166		
118	10	GG	PL19010T	2517	5	45	6	120	166	20	16	GG	PL19016T	3020	5	52	17	146	166	
	12	GG	PL19012T	2517	5	45	11	120	166		20	GG	PL19020T	3020	5	52	26.5	146	166	
	16	GG	PL19016T	3020	5	52	17	146	166											
	20	GG	PL19020T	3020	5	52	26.5	146	166											

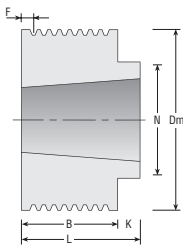

Figur 7

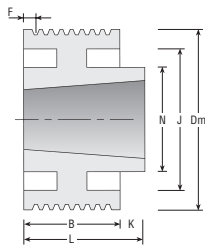

Figur 8

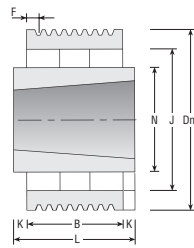

Figur 9

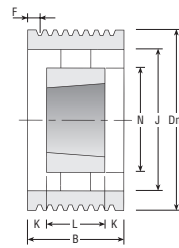

Figur 10

Dm	Spor Grooves		Part Nr.	Taper Bush Type	Fig.	L	K	N	J
	Rillen	Mat.							
200	6	GG	PL20006T	2517	6	45	3.25	120	176
	8	GG	PL20008T	2517	5	45	1.5	120	176
	10	GG	PL20010T	3020	5	52	2.5	146	176
	12	GG	PL20012T	3020	5	52	7.5	146	176
	16	GG	PL20016T	3020	5	52	17	146	176
20	GG	PL20020T	3535	4	89	8	-	176	
212	6	GG	PL21206T	2517	6	45	3.25	120	188
	8	GG	PL21208T	2517	5	45	1.5	120	188
	10	GG	PL21210T	3020	5	52	2.5	146	188
	12	GG	PL21212T	3020	5	52	7.5	146	188
	16	GG	PL21216T	3020	5	52	17	146	188
20	GG	PL21220T	3535	4	89	8	-	188	
224	6	GG	PL22406T	2517	6	45	3.25	120	202
	8	GG	PL22408T	2517	5	45	1.5	120	202
	10	GG	PL22410T	3020	5	52	2.5	146	202
	12	GG	PL22412T	3020	5	52	7.5	146	202
	16	GG	PL22416T	3020	5	52	17	146	202
20	GG	PL22420T	3535	5	89	8	-	202	
236	6	GG	PL23606T	2517	6	45	3.25	120	214
	8	GG	PL23608T	2517	5	45	1.5	120	214
	10	GG	PL23610T	3020	5	52	2.5	146	214
	12	GG	PL23612T	3020	5	52	7.5	146	214
	16	GG	PL23616T	3020	5	52	17	146	214
20	GG	PL23620T	3535	5	89	8	178	214	
250	6	GG	PL25006T	2517	9	45	3.25	120	228
	8	GG	PL25008T	2517	5	45	1.5	120	228
	10	GG	PL25010T	3020	5	52	2.5	146	228
	12	GG	PL25012T	3020	5	52	7.5	146	228
	16	GG	PL25016T	3020	5	52	17	146	228
20	GG	PL25020T	3535	5	89	8	178	228	
280	6	GG	PL28006T	2517	6	45	3.25	120	256
	8	GG	PL28008T	2517	6	52	2	146	256
	10	GG	PL28010T	3020	5	52	2.5	146	256
	12	GG	PL28012T	3020	5	52	7.5	146	256
	16	GG	PL28016T	3020	6	89	1.5	178	256
20	GG	PL28020T	3535	5	89	8	178	256	
315	6	GG	PL31506T	2517	9	45	3.25	120	285
	8	GG	PL31508T	3020	9	52	2	146	285
	10	GG	PL31510T	3535	6	89	16	178	285
	12	GG	PL31512T	3535	6	89	11	178	285
	16	GG	PL31516T	3535	6	89	1.5	178	285
20	GG	PL31520T	4040	5	102	1.5	215	285	
355	6	GG	PL35506T	3020	9	52	6.75	146	325
	8	GG	PL35508T	3020	9	52	2	146	325
	10	GG	PL35510T	3535	9	89	16	178	325
	12	GG	PL35512T	3535	9	89	11	178	325
	16	GG	PL35516T	3535	9	89	1.5	178	325
20	GG	PL35520T	4040	5	102	1.5	215	325	

Dm	Spor Grooves		Part Nr.	Taper Bush Type	Fig.	L	K	N	J
	Rillen	Mat.							
400	6	GG	PL40006T	3020	9	52	6.75	146	370
	8	GG	PL40008T	3020	9	52	2	146	370
	10	GG	PL40010T	3535	9	89	16	178	370
	12	GG	PL40012T	3535	9	89	11	178	370
	16	GG	PL40016T	3535	9	89	1.5	178	370
20	GG	PL40020T	4040	10	102	1.5	215	370	
450	6	GG	PL45006T	3020	9	52	6.75	146	420
	8	GG	PL45008T	3020	9	52	2	146	420
	10	GG	PL45010T	3535	9	89	16	178	420
	12	GG	PL45012T	3535	9	89	11	178	420
	16	GG	PL45016T	3535	9	89	1.5	178	420
20	GG	PL45020T	4040	9	102	1.5	215	420	
500	6	GG	PL50006T	3020	9	52	6.75	146	470
	8	GG	PL50008T	3020	9	52	2	146	470
	10	GG	PL50010T	3535	9	89	16	178	470
	12	GG	PL50012T	3535	9	89	11	178	470
	16	GG	PL50016T	3535	9	89	1.5	178	470
20	GG	PL50020T	5050	9	127	11	267	470	
630	6	GG	PL63006T	3020	9	52	6.75	146	600
	8	GG	PL63008T	3020	9	52	2	146	600
	10	GG	PL63010T	3535	9	89	16	178	600
	12	GG	PL63012T	3535	9	89	11	178	600
	16	GG	PL63016T	4040	9	102	1.5	215	600
20	GG	PL63020T	5050	9	127	11	267	600	
800	6	GG	PL80006T	3535	9	89	25.2	178	770
	8	GG	PL80008T	3535	9	89	20.5	178	770
	10	GG	PL80010T	4040	9	102	22.5	215	770
	12	GG	PL80012T	4040	9	102	17.5	215	770
	16	GG	PL80016T	5050	9	127	20.5	267	770
20	GG	PL80020T	5050	9	127	11	267	770	