



Rathi Transpower Pvt. Ltd. Pune

RB TECHNICAL DATA SHEET (FOR NATURAL RUBBER - 80° Shore)

S. No	Size	TORQUE		Alternating repetition	CPLG OD	Speed		Dynamic torsional rigidity of springs at				Permissible maximum misalignment		
		Nominal (T _N)	Max (T _{MAX})			CI	CS	0.75xT _N	0.5xT _N	0.25xT _N	0xT _N	Radial	Angular (gap) Max - Min	Axial
		Nm		mm	RPM		Nm/rad				mm	mm	mm	
1	RB-105-3	95.6	287	29	105	5000	5000	1484	1039	594	519	0.3	1.83	2
2	RB-116-4	146.4	439	44	116	5000	5000	3226	2258	1290	1129	0.3	2.02	2
3	RB-125-4	165.5	497	50	125	5000	5000	4526	3168	1811	1584	0.4	2.18	2
4	RB-144-6	318.3	955	95	144	4900	5000	8365	5856	3346	2928	0.4	2.51	2
5	RB-162-6	525.2	1576	158	162	4300	5000	9740	6818	3896	3409	0.5	2.83	2
6	RB-178--6	643.0	1929	193	178	3800	4900	15241	10668	6096	5334	0.5	3.11	2
7	RB-198-10	1247.8	3743	374	198	3400	4600	25382	17767	10153	8884	0.5	3.46	2
8	RB-228-11	2049.9	6150	615	228	3000	4400	36497	25548	14599	12774	0.6	3.98	3
9	RB-252-12	3068.5	9206	921	252	2700	4200	61708	43195	24683	21598	0.6	4.40	3
10	RB-285-11	4551.8	13655	1366	285	2400	3900	63713	44599	25485	22300	0.7	4.97	3
11	RB-320-12	6098.8	18296	1830	320	2100	3500	95340	66738	38136	33369	0.7	5.58	3
12	RB-360-11	8899.9	26700	2670	360	1900	3100	138427	96899	55371	48449	0.9	6.28	4
13	RB-400-10	12051.2	36154	3615	400	1700	2800	172460	120722	68984	60361	1.1	6.98	4
14	RB-450-12	18602.0	55806	5581	450	1500	2500	300115	210081	120046	105040	1.1	3.93	4
15	RB-500-14	25802.2	77407	7741	500	1350	2200	463179	324225	185272	162113	1.1	3.49	4
16	RB-560-10	31003.4	93010	9301	560	1200	2000	568260	397782	227304	198891	1.5	2.93	2
17	RB-630-12	41997.8	125993	12599	630	1050	1800	862645	603852	345058	301926	1.5	3.30	2
18	RB-710-12	75000.2	225001	22500	710	950	1600	1467689	1027382	587075	513691	1.8	3.72	2
19	RB-800-14	100000.2	300001	30000	800	850	1400	2178328	1524830	871331	762415	1.8	4.19	2
20	RB-900-16	154997.6	464993	46499	900	750	1250	3780605	2646423	1512242	1323212	1.8	4.71	2

Misalignments

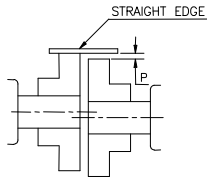

Radial Misalignment

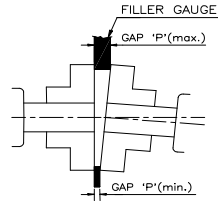

Angular Misalignment

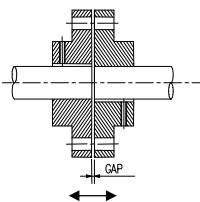

Axial Misalignment

Misalignment data valid for shock free operation and Ambient temperature from -30° to +80° C

Permissible initial misalignment = Maximum misalignment capacity X Speed factor (Sn)

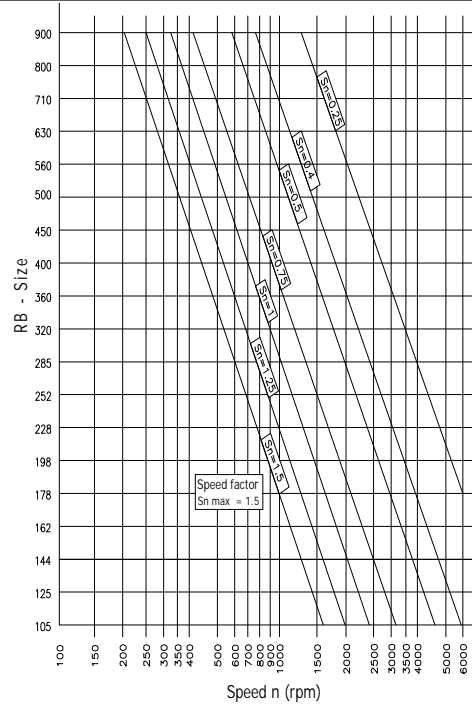

RATHI TRANSPOWER PVT. LTD.
Rathi Chambers, 7, Deccan college road, Pune - 411006 (INDIA)
Phone : 91-20-30517201, Fax : 91-20-30517212
E-mail : enquiry@rathigroup.com
Website : www.rathicouplings.com

CUSTOMER :

REF.NO. -

DOC.NO.

T D - 204 / 0

PREPARED BY : SVB

DMRN -

PAGE

SHEET 1 OF 3

APPROVED BY : DR.SBP

DATE

1.12.08



Rathi Transpower Pvt. Ltd. Pune

RB TECHNICAL DATA SHEET (FOR POLYURETHANE - 90° Shore)

S. No	Size	TORQUE		Alternating repetition	CPLG OD	Speed		Dynamic torsional rigidity of springs at				Permissible maximum misalignment		
		Nominal (T _N)	Max (T _{MAX})			CI	CS	0.75xT _N	0.5xT _N	0.25xT _N	0xT _N	Radial	Angular (gap) Max - Min	Axial
		Nm		mm		RPM		Nm/rad				mm	mm	mm
1	RB-105-3	143.4	430	43	105	5000	5000	2225.9	1558	890	779	0.3	1.83	2
2	RB-116-4	219.6	659	66	116	5000	5000	4838.6	3387	1935	1694	0.3	2.02	2
3	RB-125-4	248.25	745	74	125	5000	5000	6789.5	4753	2716	2376	0.4	2.18	2
4	RB-144-6	477.45	1432	143	144	4900	5000	12547.8	8783	5019	4392	0.4	2.51	2
5	RB-162-6	787.8	2363	236	162	4300	5000	14610.4	10227	5844	5114	0.5	2.83	2
6	RB-178--6	964.5	2894	289	178	3800	4900	22861.0	16003	9144	8001	0.5	3.11	2
7	RB-198-10	1871.7	5615	562	198	3400	4600	38073.0	26651	15229	13326	0.5	3.46	2
8	RB-228-11	3074.85	9225	922	228	3000	4400	54746.1	38322	21898	19161	0.6	3.98	3
9	RB-252-12	4602.75	13808	1381	252	2700	4200	92561.3	64793	37025	32396	0.6	4.40	3
10	RB-285-11	6827.7	20483	2048	285	2400	3900	95569.4	66899	38228	33449	0.7	4.97	3
11	RB-320-12	9148.2	27445	2744	320	2100	3500	143010.3	100107	57204	50054	0.7	5.58	3
12	RB-360-11	13349.85	40050	4005	360	1900	3100	207639.9	145348	83056	72674	0.9	6.28	4
13	RB-400-10	18076.8	54230	5423	400	1700	2800	258690.4	181083	103476	90542	1.1	6.98	4
14	RB-450-12	27903	83709	8371	450	1500	2500	450172.9	315121	180069	157561	1.1	3.93	4
15	RB-500-14	38703.3	116110	11611	500	1350	2200	694768.6	486338	277907	243169	1.1	3.49	4
16	RB-560-10	46505.1	139515	13952	560	1200	2000	852389.3	596673	340956	298336	1.5	2.93	2
17	RB-630-12	62996.7	188990	18899	630	1050	1800	1293967.9	905778	517587	452889	1.5	3.30	2
18	RB-710-12	112500.3	337501	33750	710	950	1600	2201533.0	1541073	880613	770537	1.8	3.72	2
19	RB-800-14	150000.3	450001	45000	800	850	1400	3267492.4	2287245	1306997	1143622	1.8	4.19	2
20	RB-900-16	232496.4	697489	69749	900	750	1250	5670907.1	3969635	2268363	1984817	1.8	4.71	2

Misalignments

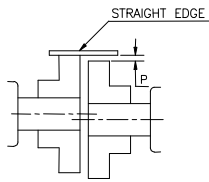

Radial Misalignment

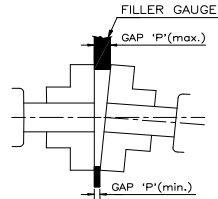

Angular Misalignment

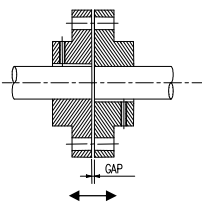

Axial Misalignment

Misalignment data valid for shock free operation and Ambient temperature from -30° to +80° C

Permissible initial misalignment = Maximum misalignment capacity X Speed factor (Sn)

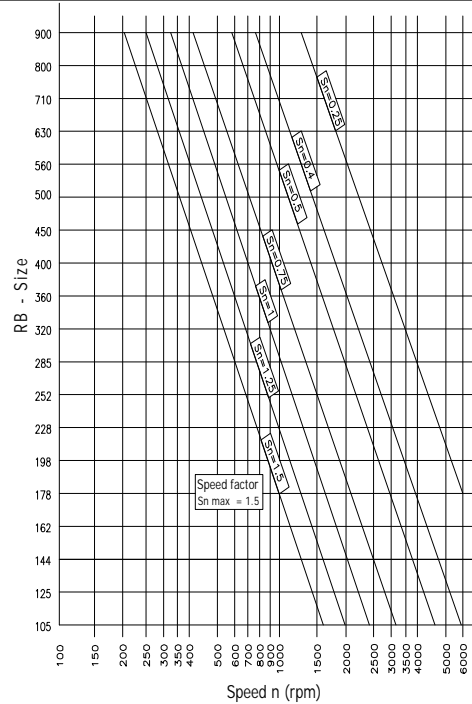

RATHI TRANSPOWER PVT. LTD.
Rathi Chambers, 7, Deccan college road, Pune - 411006 (INDIA)
Phone : 91-20-30517201, Fax : 91-20-30517212
E-mail : enquiry@rathigroup.com
Website : www.rathicouplings.com

CUSTOMER :

REF.NO. -

DOC.NO.

T D - 204 / 0

PREPARED BY : SVB

DMRN -

PAGE

SHEET 2 OF 3

APPROVED BY : DR.SBP

DATE

1.12.08



Rathi Transpower Pvt. Ltd. Pune

RB TECHNICAL DATA SHEET (FOR HYTREL - 98° Shore)

S. No	Size	TORQUE		Alternating repetition	CPLG OD	Speed		Dynamic torsional rigidity of springs at				Permissible maximum misalignment		
		Nominal (T _N)	Max (T _{MAX})			CI	CS	0.75xT _N	0.5xT _N	0.25xT _N	0xT _N	Radial	Angular (gap) Max - Min	Axial
		Nm				RPM		Nm/rad				mm	mm	mm
1	RB-105-3	239.0	717	72	105	5000	5000	3709.9	2597	1484	1298	0.3	1.83	2
2	RB-116-4	366.0	1098	110	116	5000	5000	8064.4	5645	3226	2823	0.3	2.02	2
3	RB-125-4	413.8	1241	124	125	5000	5000	11315.9	7921	4526	3961	0.4	2.18	2
4	RB-144-6	795.8	2387	239	144	4900	5000	20913.0	14639	8365	7320	0.4	2.51	2
5	RB-162-6	1313.0	3939	394	162	4300	5000	24350.7	17045	9740	8523	0.5	2.83	2
6	RB-178-6	1607.5	4823	482	178	3800	4900	38101.7	26671	15241	13336	0.5	3.11	2
7	RB-198-10	3119.5	9359	936	198	3400	4600	63455.1	44419	25382	22209	0.5	3.46	2
8	RB-228-11	5124.8	15374	1537	228	3000	4400	91243.5	63870	36497	31935	0.6	3.98	3
9	RB-252-12	7671.3	23014	2301	252	2700	4200	154268.9	107988	61708	53994	0.6	4.40	3
10	RB-285-11	11379.5	34139	3414	285	2400	3900	159282.3	111498	63713	55749	0.7	4.97	3
11	RB-320-12	15247.0	45741	4574	320	2100	3500	238350.4	166845	95340	83423	0.7	5.58	3
12	RB-360-11	22249.8	66749	6675	360	1900	3100	346066.5	242247	138427	121123	0.9	6.28	4
13	RB-400-10	30128.0	90384	9038	400	1700	2800	431150.7	301806	172460	150903	1.1	6.98	4
14	RB-450-12	46505.0	139515	13952	450	1500	2500	750288.2	525202	300115	262601	1.1	3.93	4
15	RB-500-14	64505.5	193517	19352	500	1350	2200	1157947.7	810563	463179	405282	1.1	3.49	4
16	RB-560-10	77508.5	232526	23253	560	1200	2000	1420648.9	994454	568260	497227	1.5	2.93	2
17	RB-630-12	104994.5	314984	31498	630	1050	1800	2156613.1	1509629	862645	754815	1.5	3.30	2
18	RB-710-12	187500.5	562502	56250	710	950	1600	3669221.7	2568455	1467689	1284228	1.8	3.72	2
19	RB-800-14	250000.5	750002	75000	800	850	1400	5445820.6	3812074	2178328	1906037	1.8	4.19	2
20	RB-900-16	387494.0	1162482	116248	900	750	1250	9451511.8	6616058	3780605	3308029	1.8	4.71	2

Misalignments

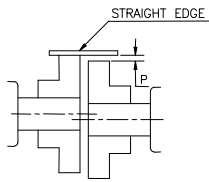

Radial Misalignment

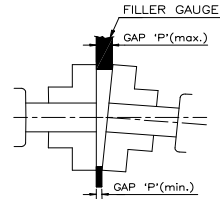

Angular Misalignment

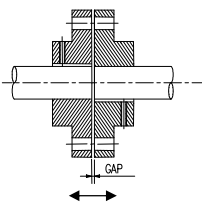

Axial Misalignment

Misalignment data valid for shock free operation and Ambient temperature from -30° to +80° C

Permissible initial misalignment = Maximum misalignment capacity X Speed factor (Sn)

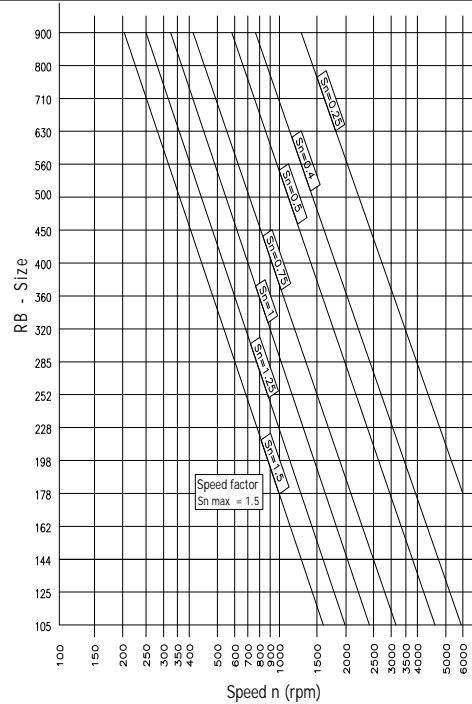

RATHI TRANSPOWER PVT. LTD.
Rathi Chambers, 7, Deccan college road, Pune - 411006 (INDIA)
Phone : 91-20-30517201, Fax : 91-20-30517212
E-mail : enquiry@rathigroup.com
Website : www.rathicouplings.com

CUSTOMER :

REF.NO. -

DOC.NO.

T D - 204 / 0

PREPARED BY : SVB

DMRN -

PAGE

SHEET 3 OF 3

APPROVED BY : DR.SBP

DATE

1.12.08